

Data

Part No.	Length „a“	Remarks	Identification
115 330 07 03	342 ± 2	LH threads mounted at the left seen in driv.dir.	sprayed black

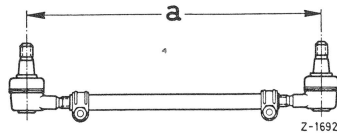

Fig. 1

Approved Grease Types for Ball Joints

Refer to pertinent specifications on page 267	Shell Retinax Veedol Multipurpose Optimol Optimol Olit	Gasolin Multipurpose Grease Aral Multipur- Aral Multipurpose Grease
---	--	---

Tightening Torques	Nm	(kpm)
Castle nuts for attaching track rod to steering arms	35	(3.5)
Hex. bolt to clamp of track rod	20	(2)

Special Tools

Puller for track rod	136 589 12 33 00
Assembly bushing for flat wire clamping ring (Fig. 6)	self-made
Assembly bushing for plastic ring (Fig. 6)	self-made

46.1 Removal and Installation of Track Rod

Removal

1 Unscrew castle nuts on joints for track rod (6) after removing cotter pins (Fig. 2).

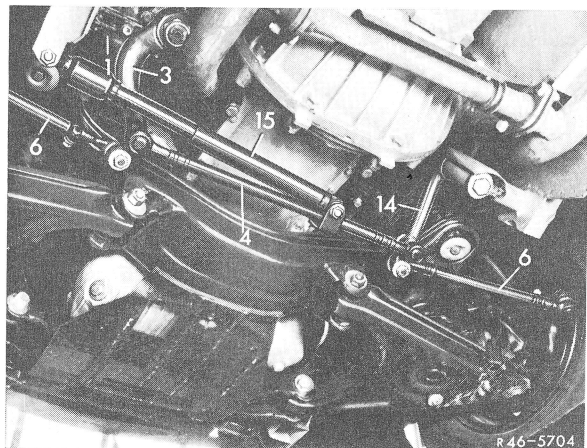

Fig. 2

- | | |
|--------------|------------------------------|
| 1 Steering | 6 Track rod |
| 3 Pitman arm | 14 Intermediate steering arm |
| 4 Drag link | 15 Steering shock absorber |

2 Remove track rod (20) from steering arms by means of puller (36) (Fig. 3).

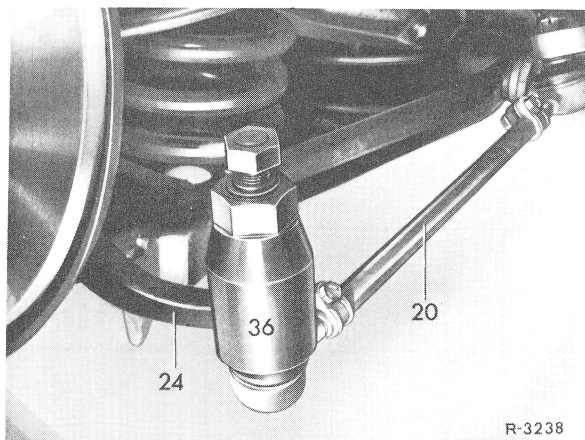

Fig. 3

- | | |
|-------------------------|-----------|
| 20 Track rod | 36 Puller |
| 24 Steering knuckle arm | |

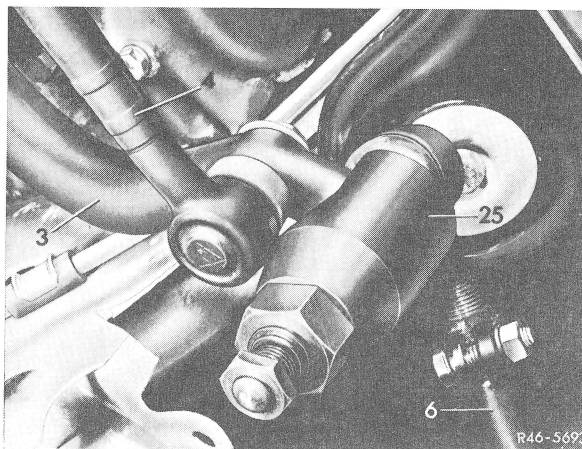

Fig. 4

- | | |
|--------------|-------------|
| 3 Pitman arm | 6 Track rod |
| 4 Drag link | 25 Puller |

Checkup

3 Check joints of track rods. Track rods are provided with 22 mm dia. ball joints. Replace entire track rod end if one joint is defective.

4 Check rubber sleeves (10). **If rubber sleeve on a used joint shows evidence of damage, renew complete joint.** If rubber sleeve has been damaged when removing track rod, it will be sufficient to renew rubber sleeve. For this purpose, remove flat wire clamping ring (9) and pull off sleeve together with plastic fastening ring (10) (Fig. 7).

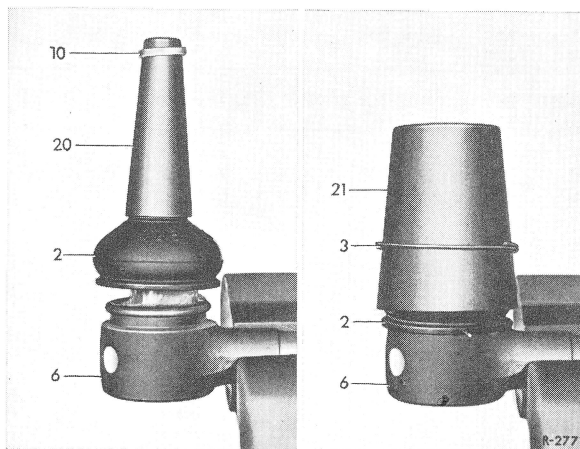

Fig. 5

- | |
|--|
| 2 Rubber sleeve |
| 3 Flat wire clamping ring |
| 6 Track rod end |
| 10 Plastic fastening ring |
| 20 Assembly sleeve for plastic ring |
| 21 Assembly sleeve for flat wire clamping ring |

Make two assembly sleeves according to dimensions shown in Fig. 6 to insert fastening rings (3 and 10). The flat wire clamping ring (3) in particular will be hard to install without these assembly sleeves (Fig. 7).

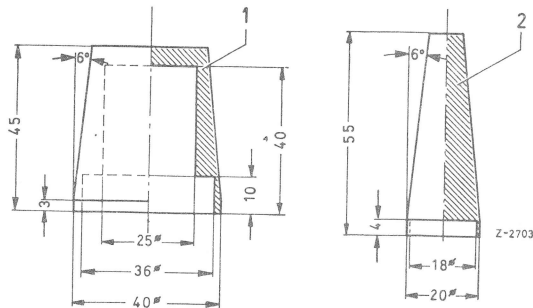

Fig. 6

- 1 Assembly sleeve for flat wire clamping ring
- 2 Assembly sleeve for plastic ring

Note: Both track rods and the drag link are provided with service-free joints, that is, they are provided with a grease charge for life. **On service-free joints the seal against the penetration of dirt is of decisive importance for the life of the joints. A damaged rubber sleeve should therefore be replaced immediately, since otherwise the penetrating dirt will lead to pertinent wear. For this reason, the joints should be carefully and regularly inspected.**

Installation

Mount track rods in such a manner that the track rod end **with lefthand threads** is **always** at the **left** (seen in driving direction).

5 Clean ball pins as well as conical seats in steering arms perfectly from grease. Then push ball pins tightly into cone of steering arm, **screw-on castle nut** and tighten. Tightening torque 35 Nm (3.5 kpm) – reference value.

6 Check wheel adjusting values on front axle („axles“ 40.1–320).

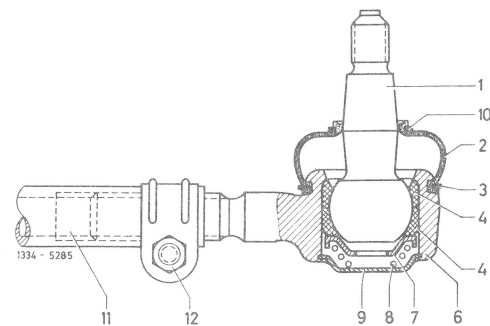

Fig. 7

- 1 Ball pin
- 2 Rubber sleeve
- 3 Flat wire clamping ring
- 4 Plastic bearing shell
- 6 Track rod end
- 7 Thrust plate
- 8 Compression spring
- 9 Closing cover
- 10 Plastic fastening ring
- 11 Track rod tube
- 12 Clamp